

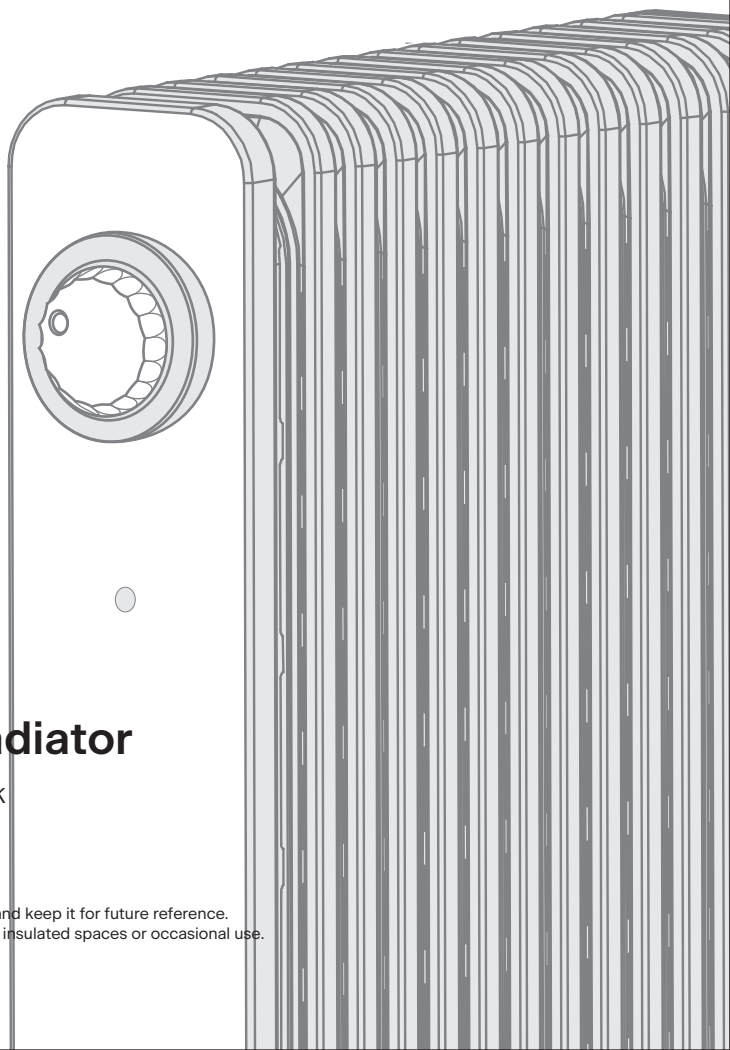

Phoenix 13M

User Manual



Oil Filled Radiator

MODEL: PHO25A3ABGUK

Please read this manual carefully and keep it for future reference.
The device is only suitable for well insulated spaces or occasional use.

Thanks for Choosing PELONIS!

Your support is pivotal and
we hope you enjoy it!

Follow us:



@Pelonis UK



@pelonis.uk

Contents

Important Safeguards	01
Product Overview	03
Installation	04
Operation Instructions	06
Troubleshooting	08
Cleaning And Maintenance	10
Specifications	11

Important Safeguards

CAUTION

1. Some parts of this product can become very hot and cause burns. Particular attention has to be given where children and vulnerable people are present.
2. This heater is filled with a precise quantity of special oil. Repairs requiring opening of oil-container are only to be made by the manufacturer or his service agent who should be contacted if there is an oil leak. When scrapping the heater, follow the regulations concerning the disposal of oil.
3. Correct Disposal of this product This marking indicates that this product should not be disposed with other household wastes throughout the EU. To prevent possible harm to the environment or human health from uncontrolled waste disposal, recycle it responsibly to promote the sustainable reuse of material resources. To return your used device, please use the return and collection systems or contact the retailer where the product was purchased. They can take this product for environmental safe recycling.
4. This heater cannot achieve accurate temperature control of the environment, and thus cannot be used as insulation device for storage environment, items, animals and plants.
5. Do not use this heater if it has been dropped.
6. Do not use if there are visible signs of damage to the heater.
7. Use this heater on a horizontal and stable surface.
8. Details concerning precautions during user maintenance.
9. Consider all the information, including the information contained in the "CLEANING AND MAINTENANCE INSTRUCTION" chapter.
10. Household use only.

WARNING

1. Warning: In order to avoid overheating, do not cover the heater.
2. If the supply cord is damaged, it must be replaced by the manufacturer or its service agent or a similarly qualified person in order to avoid a hazard.
3. This appliance can be used by children aged from 8 years and above and persons with reduced physical, sensory or mental capabilities or lack of experience and knowledge if they have been given supervision or instruction concerning use of the appliance in a safe way and understand the hazards involved. Children shall not play with the appliance. Cleaning and user maintenance shall not be made by children without supervision.
4. The heater must not be located immediately below a socket-outlet.
5. Do not use this heater in the immediate surroundings of a bath, a shower or a swimming pool.
6. Children of less than 3 years should be kept away unless continuously supervised. Children aged from 3 years and less than 8 years shall only switch on/off the appliance provided that it has been placed or installed in its intended normal operating position and they have been given supervision or instruction concerning use of the appliance in a safe way and understand the hazards involved. Children aged from 3 years and less than 8 years shall not plug in, regulate and clean the appliance or perform user maintenance.
7. Do not use this heater in small rooms when they are occupied by persons not capable of leaving the room on their own, unless constant supervision is provided.
8. To reduce the risk of fire, keep textiles, curtains, or any other flammable material a minimum distance of 1 m from the air outlet.

Product Overview

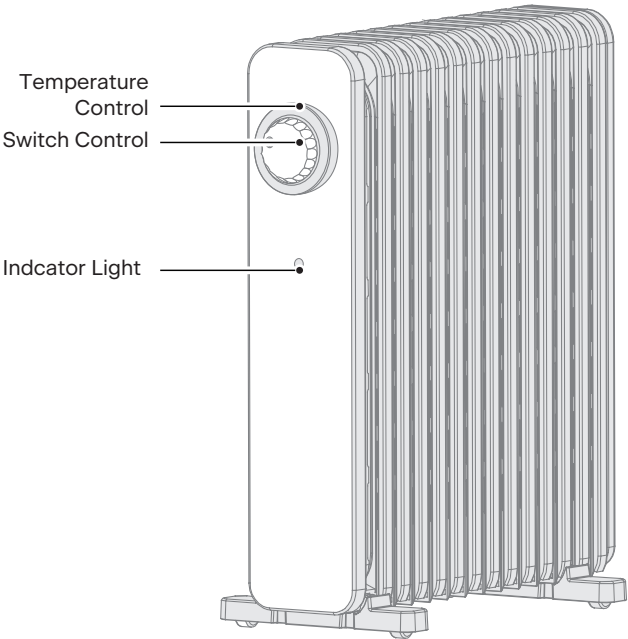

[Note]

All the pictures in this manual are for explanation purpose only. Any discrepancy between the real object and the illustration in the drawing shall be subject to the real subject.

Installation

Instructions

1. Turn the heater body upside down with the bottom facing up.
2. As shown in Figure 1, align the mounting buckles of a set of foot components with the holes of the 2nd and 3rd heat sinks on one side, press in the direction of the arrow, and the buckle on the foot will drop into the hole of the heat sink. Repeat the operation to install the other foot on the opposite side.

Figure 1

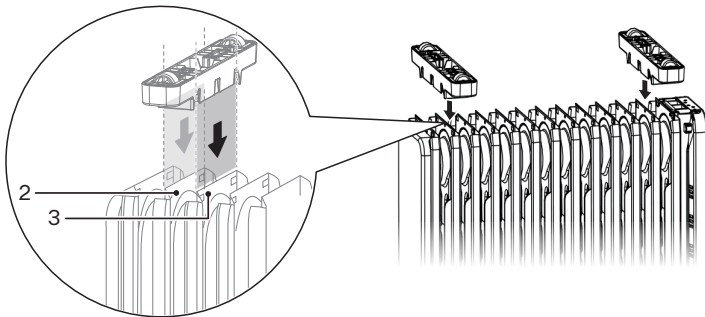

3. As shown in Figure 2, confirm that the foot is securely installed before placing the heater upright, with the wheels on the ground.

Figure 2

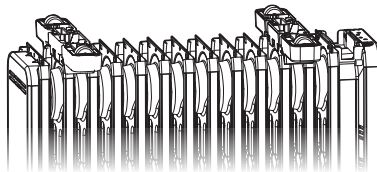

Instructions for Removing the Foot Wheels

1. As shown in Figure 3, press down on one side of the foot end with force, and lift the other side up with force.

Figure 3

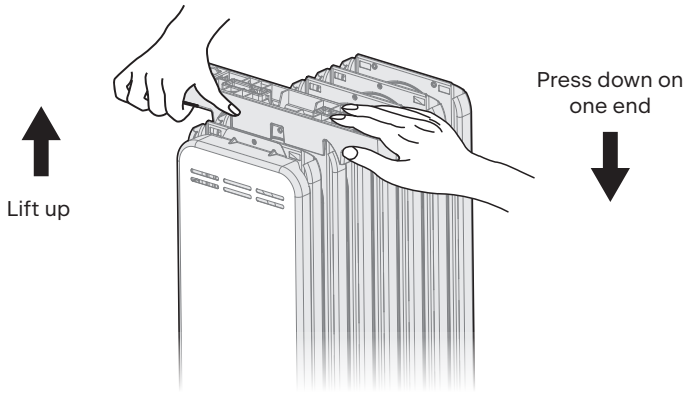

Operating Instructions

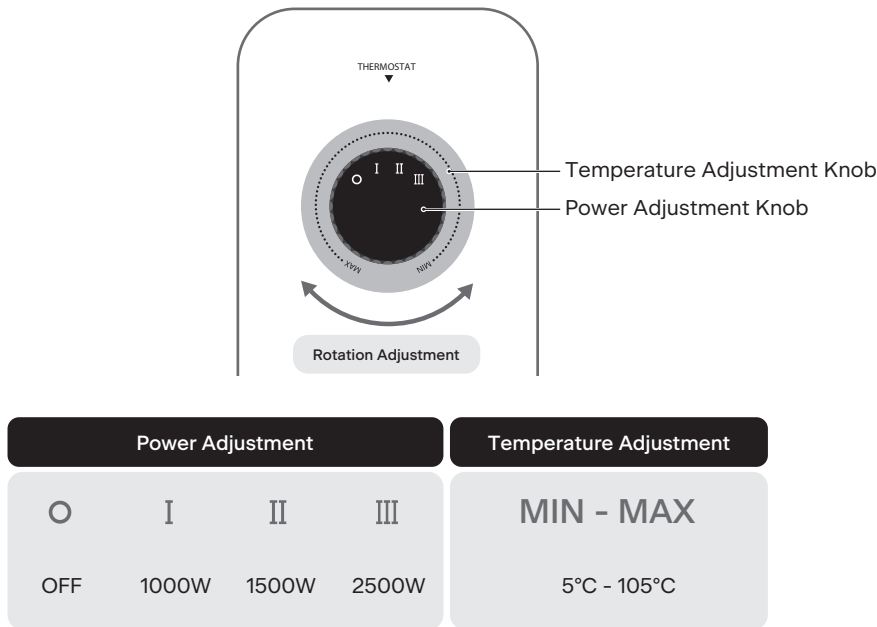

Note: 5°C-105°C is the temperature range of the product's built-in temperature controller.

1. Inspection before start

- The power cord shall not be damaged or fractured.
- Please verify the rated current of the power socket is in line with the requirements in the table above and is equipped with a safety grounding device before use; otherwise, replace the socket.

2. Start and power selection

- StartPlug in the power, clockwise turn the thermostat knob to the "MAX" mark position, then turn on the power switch, the heater starts to work.
- Power selectionUnder normal circumstances, please use the maximum power "III" gear for rapid heating. If the room temperature reaches a suitable temperature, please choose a lower power "II" or "I" gear to reduce energy consumption so as to prevent the room becoming overheated.
- Inspection method
Insert the power plug into the socket and start for use; after about half an hour, turn off and pull out the plug. Check whether the plug pins are hot; replace the socket if so (more than about 50 °C) to avoid burning the plug or even causing a fire caused by overheating of the socket due to poor contact.

3. Temperature adjustment

- During use, if you feel it is necessary to lower the room temperature since it is too high, you can use the following adjustment modes:
 - Turn the power switch to gear "II" or "I".
 - Counterclockwise turn the thermostat knob back by a certain angle, for which it indicates that the set temperature is lower when the temperature indication is closer to the "MIN" position.

4. Stop

- Turn the power switch to indication point "O", and then pull out the power plug.

5. Movement of the heater

- To move the heater, turn it off first, and pull out the power plug; then push the body to make the four casters below the body to roll.

[Note]

To use the machine for the first time or to re-insert the socket, please pay attention to check whether the plug and the socket are fitted well.

Troubleshooting

Operation of your appliance can lead to errors and malfunctions. The following tables contain possible causes and notes for resolving an error message or malfunction. It is recommended to read the tables carefully below in order to save your time and money that may cost for calling to the service center.

Fault symptoms	Fault description
The power indicator light does not turn on and the device does not work after connecting to the power source.	The plug is not inserted properly. Please check if the plug is correctly inserted into the socket.
The device suddenly stops heating during operation.	The temperature has exceeded the threshold of the limit switch. Please wait for the device to cool down before using it again.
The plug overheats or ignites	The current overload of the socket or the aging of the socket causes the contact to loosen. Please use sockets that meet the requirements and standards of their respective countries or regions.
Burnt odor and inability to operate (caused by the accumulation of dust inside).	The machine is used in an environment with a lot of dust or hair. Recommended to place the machine in a clean and well-ventilated area.

Item	Symbol	Value	Unit	Item	Unit
Heat output				Type of heat input, for electric local space heaters only (select one)	
Nominal heat output	P_{nom}	1.2	kW	Manual heat charge control with integrated thermostat	[no]
Minimum heat output (indicative)	P_{min}	1.0	kW	Manual heat charge control with room and/or outdoor temperature feedback	[no]
Maximum continuous heat output	P_{max}	1.2	kW	Electronic heat charge control with room and/or outdoor temperature feedback	[no]
Auxiliary electricity consumption				Fan assisted heat output	[no]
At nominal heat output	e_{lmax}	0.000	kW	Type of heat output/room temperature control (select one)	
At minimum heat output	e_{lmin}	0.000	kW	Single stage heat output and no room temperature control	[no]
In standby mode	e_{lmin}	0.000	W	Two or more manual stages, no room temperature control	[no]
				With mechanic thermostat room temperature control	[yes]
				With electronic room temperature control	[no]
				Electronic room temperature control plus day timer	[no]
				Electronic room temperature control plus week timer	[no]
				Other control options (multiple selections possible)	[no]
				Room temperature control, with presence detection	[no]
				With distance control option	[no]
				With adaptive start control	[no]
				With working time limitation	[no]
				With black bulb sensor	[no]
Contact details:		Lifestyle Orchestra Co. Pte. Ltd. 158 CECIL STREET#07-01/02 SINGAPORE (069545)			

CLEANING AND MAINTENANCE

Precautions

- The electric heater should be cleaned regularly to wipe out the dust on the surface of flanges. As this may influence the radiating efficiency.
- Disconnect electricity supply and allow radiator to cool, wipe out dust with a soft damp cloth. Do not use detergent or abrasives.
- Do not scrap the surfaces of flanges with sharp hard tools, to avoid surfaces getting rusty, because of damage of the paint coat.

Disposal And Recycling

Important instructions for environment



This product complies with EU WEEE Directive and bears a classification symbol for waste electrical and electronic equipment (WEEE).

This marking indicates that this product should not be disposed with other household wastes throughout the EU. To prevent possible harm to the environment or human health from uncontrolled waste disposal, recycle it responsibly to promote the sustainable reuse of material resources. To return your used device, please use the return and collection systems or contact the dealer where the product was purchased. They can take this product for environmental safe recycling.

Specifications

Model	Power Supply	Rated Power
PHO25A3ABGUK	220-240V~,50Hz	2500W
Dimension	Cord Lenth:	
16.9" × 4.9" × 21.5"	5.7 ft / 1.73 m	
430mm × 125mm × 545mm		

Pelonis Customer Care

Default 12-Month Warranty

This appliance is covered by Pelonis warranty for 12 months from the date of its original purchase.

Extend Your Warranty

Send email to **cs_eu@pelonis.com** to extend your warranty.

*Please include your Amazon purchase order number, date of purchase when sending the email for quick activation of your extended warranty.

The warranty will not apply in cases of:

1. Accident, misuse, or repairs performed by unauthorized personnel.
2. Any unit that has been tampered with or used for commercial purposes.
3. Normal wear and tear of wearable parts.
4. Use of force, damage caused by external influences.
5. Damage caused by non-observance of the User Manual, e.g. connection to an unsuitable mains supply or noncompliance with the instructions.
6. Partially or completely dismantled appliances.
7. Defects caused by or resulting from damages from shipping or from repairs, service, or alteration to the product or any of its parts that have been performed by a repair person not authorized by Pelonis.

*We can only provide after-sales service for products sold by Pelonis authorized Amazon brand stores, retailers and distributors. If you purchased your unit from elsewhere, please contact your seller for returns and warranty.

**For warranty or service inquiries regarding,
please contact us at the following:**

cs_eu@pelonis.com



UK	RP
-----------	-----------

Company:
TC Kangbridge Ltd

Address:
TC Lumionous house, 300South row,
Milton keynes, MK9 2FR

Mail:
epr@tangcheng.top

 amazon.co.uk/pelonis

Looking for help?

Contact us to get expert support.

 cs_eu@pelonis.com